

LEVER OPERATED DIRECTIONAL CONTROL VALVE

MODEL : 4DCL06

1 Description

Completely encapsulated mechanism for protection against dirt.
Five chamber design for better reduction dynamic forces and longer life.

Available as spring centered, spring offset or detented model.
Operating head can be rotated by 90 x 4 around spool axis for flexibility in mounting.

Mounting interface conforms to International and national standards.

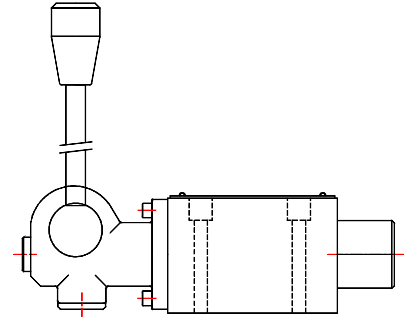

2 Section

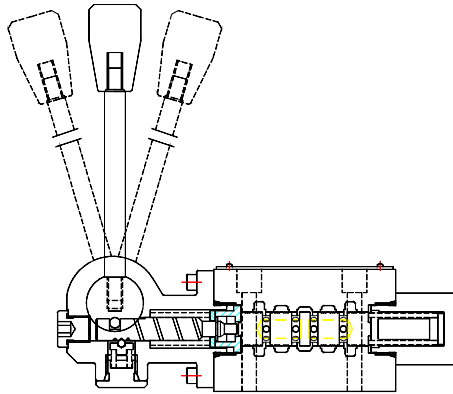

Hydraulic Symbol

2 position spring offset

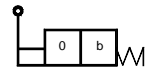

2 position detented

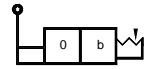

3 position spring offset

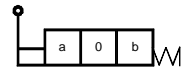

3 position detented

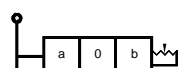

3 Unit Dimensions

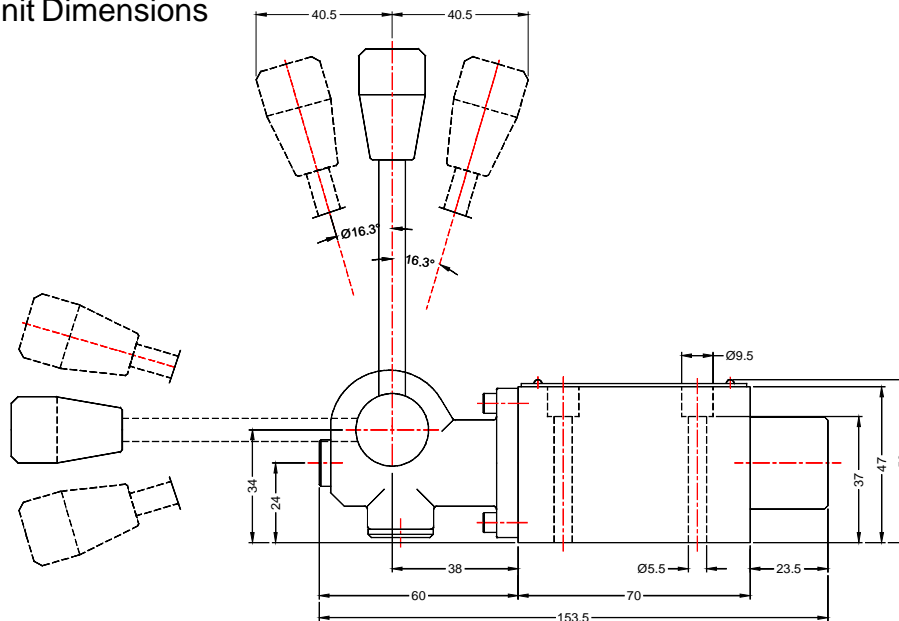

Dimensions in mm.

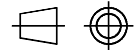

Note:- Valve mounting screws M5x45L
Tightening torque 8.9 N-m
(Out of scope of supply)

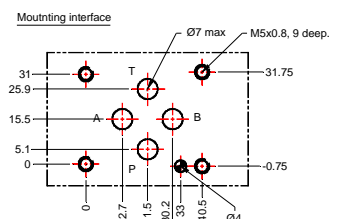

PRISM HYDRAULICS PVT. LTD.
B-23 Angol Indl. Estate
Udyambag,
Belgaum - 590 008. INDIA.

Phone :- +91-(0831)-2443448
Fax :- +91-(0831)-4202340
E-mail :- prismhydraulics@gmail.com

LEVER OPERATED DIRECTIONAL CONTROL VALVE MODEL : 4DCL06

4 Technical Specifications

Construction.....	Spool type
Mounting style	Subplate body
Interface	As per ISO 4401 -AC-05-4-A and IS10187-7 mm diameter nominal port
Mounting position	Optional
Flow direction	As per spool
Operating pressure	For port P,A and B 315 bar For port T..... 160 bar
Actuating force of spring centered assembly.....	20 N max
Detent assembly	30 N max
Maximum flow handling capacity	60 l/min.
Hydraulic medium	Mineral oil
Viscosity range	16 to 68 cSt
Temperature range	-10 to +80 degree celcius (Do not exceed viscosity limits at extreme temperatures for efficient running of pump)
Fluid cleanliness requirement	As per ISO code 16/13
Mass	1.5 kg
Performance	Refer graph

Performance curve
Oil used:-ISO VG46,Viscosity:46cSt @ 40° c, Temperature @ test 40°

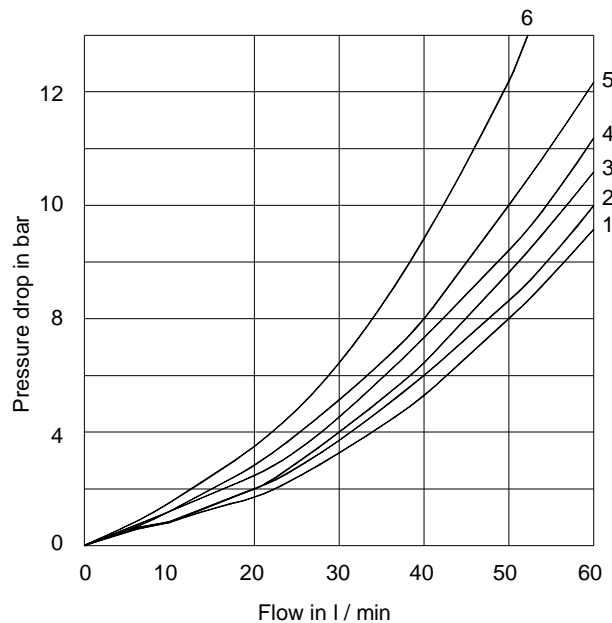

		Spool type												
		A	B	C	D	E	F	G	H	J	L	M	P	
Direction of flow	P-A	3	3	3	3	2	2	6	2	2	2	2	2	
	P-B	3	3	3	3	2	2	6	2	2	2	2	2	
	A-T	-	-	4	4	4	2	6	1	1	1	4	2	
	B-T	-	-	1	1	4	2	6	1	1	4	4	2	
	P-T	-	-	-	-	-	-	5	3	-	-	-	-	

LEVER OPERATED DIRECTIONAL CONTROL VALVE

MODEL : 4DCL06

5 Subplate

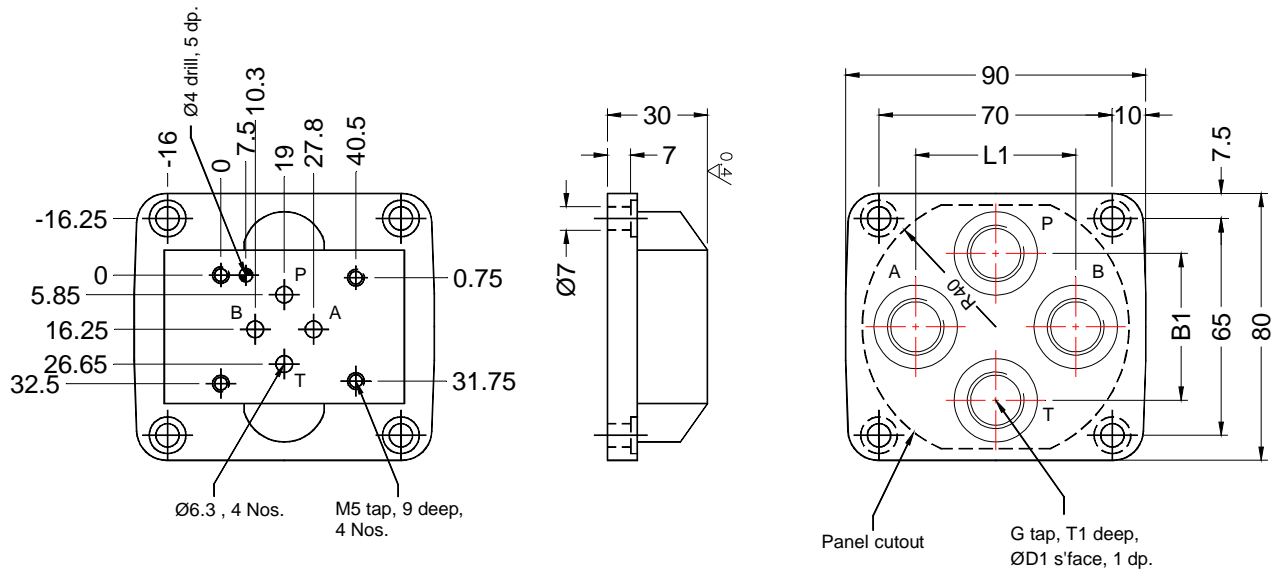

Subplate	B1	D1	G	L1	T1
CTP03G01	34	22	G1/4	36	12
CTP03G02	44	25	G3/8	48	12

6 Ordering code

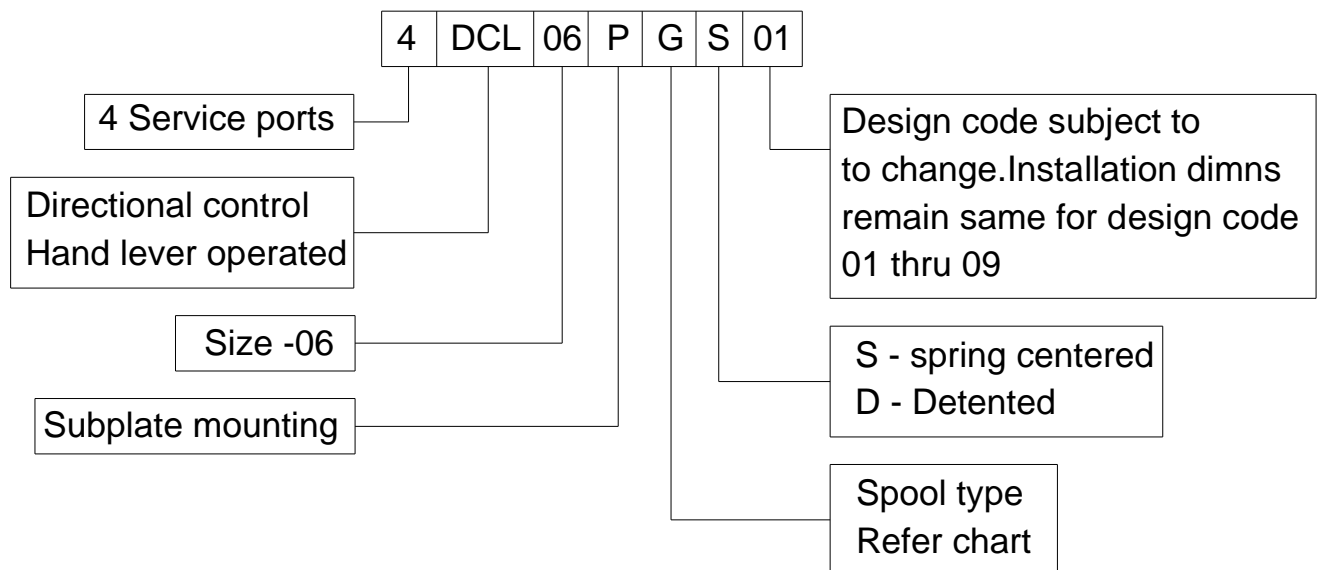

Spool chart

Type	Symbol	Crossover	Type	Symbol	Crossover
A			J		
C			M		
D			P		
E			T		
F					
G					
H					